



Mission

The mission of the Emmet County Nature Center Foundation is to promote environmental education for all residents and visitors of Emmet County by specifically organizing the fundraising effort for the construction and upkeep of the Emmet County Conservation Nature Center to be built at the Wolden Recreation Area.

The Emmet County Nature Center will:

- provide increased opportunities in conservation, education and recreation
- provide a display area and information for visitors
- offer programming for all ages
- be the cornerstone for the Emmet County Conservation park system
- provide expansion for the environmental education program
- provide a location to showcase the natural resources and ecosystems of Emmet County

The Nature Center contains:

- Classroom/Meeting Room
- Display area
- Emmet County Conservation Board staff offices
- Storage space



This nature/learning center will give the county conservation staff a location to bring school students for field trips. The learning center will give us the opportunity to have a classroom setting along with being able to use the natural ecosystems in the park complex. Additional indoor space will also alleviate any problems for field trips on rainy or cold days.

This facility will bring increased recreational opportunities for both Emmet County residents and nonresidents. The nature center will be open to the public and allow families to come and learn about their environment. This opportunity will be provided in a safe and fun setting for families to spend time together. While in the area, they will be able to walk the trails, have a picnic, visit the nature center, and enjoy the lakes for swimming or fishing. In addition, people camping will have another activity to enjoy while staying in the park.

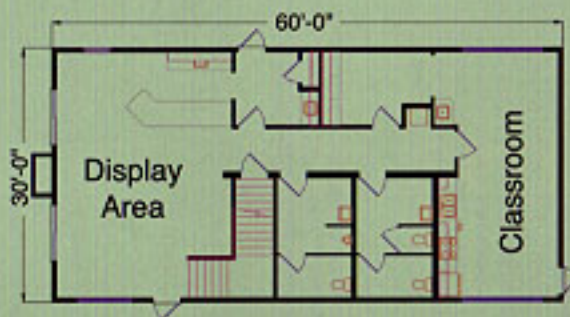

People often forget there are many ecosystems and habitat areas that are present and very local to Iowa that need to be conserved in the present and preserved for the future. This project will give us one more opportunity to expose and educate people about these habitats and ecosystems. This education will happen right in the midst of these habitats with prairie and wetland areas very near the site of this building. When people visit the nature center, they will be able to spend some time outside exploring the surroundings, along with spending time inside the building looking at the exhibits and doing hands-on activities. The displays in the nature center will give visitors a chance to experience wildlife and their environment first hand.

These experiences are vital to the preservation of our outdoor heritage in Emmet County. With the current increase in fossil fuel prices and concerns over waste emissions, we plan to implement a working model of practical conservation practices right here at home. This becomes a win-win situation and demonstrates good stewardship of natural resources and cost efficiency for the future of this building and the county conservation budget.

Another benefit of the nature center will be the expansion in quality of our other educational programming. This building will not only give us a place to hold programs and bring groups to the park, but it will also give us the much needed storage of supplies for programs we do at the schools and in other settings.

